

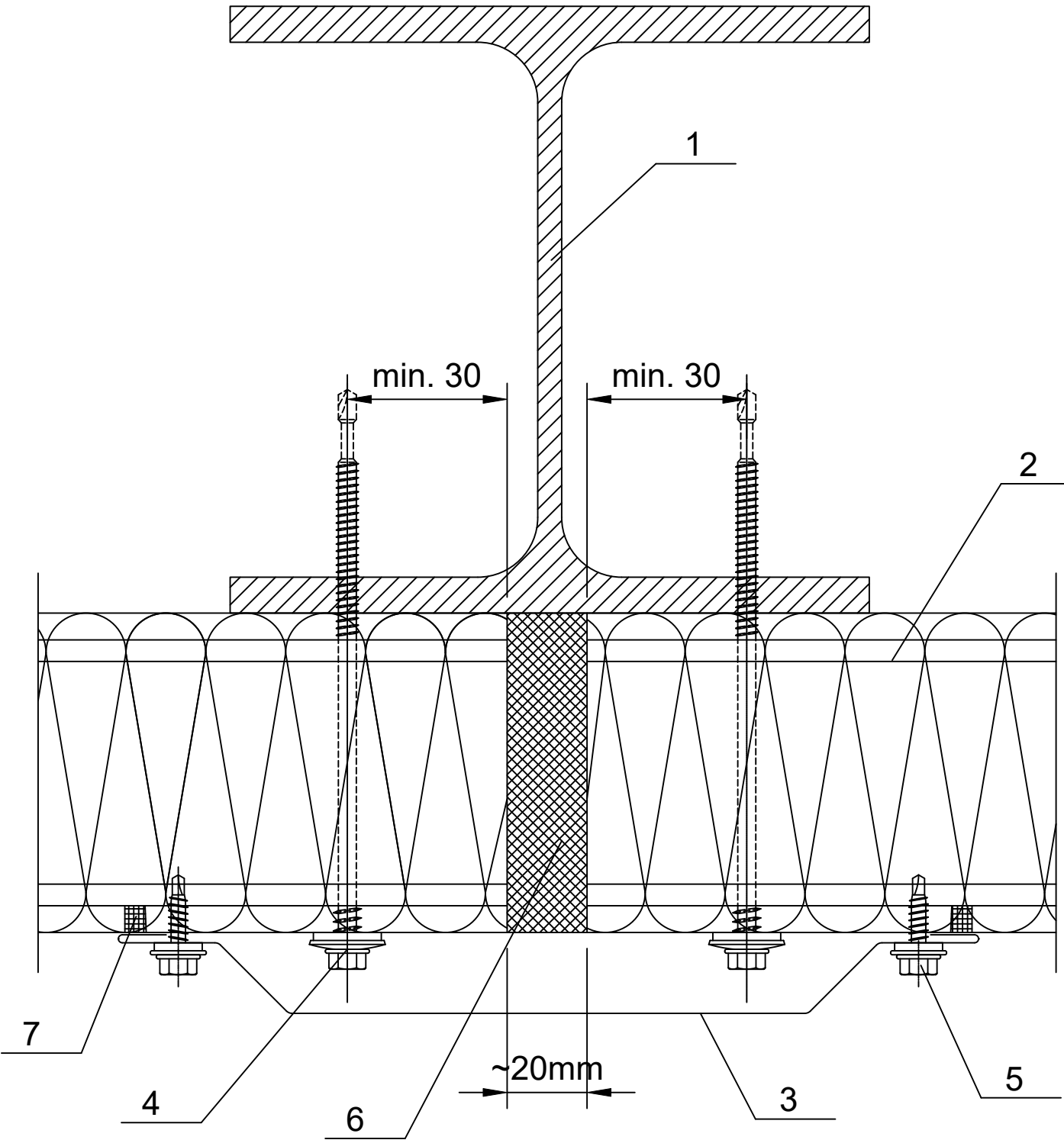

Contents of drawing

Fixing of Ruukki SP2B PIR panel
with steel column, extreme support.
Horizontal panel arrangement.

Date	Rev. date	Work nr.	Drw. nr.	Rev.
Drawn by Ruukki	Rev.	M27/S26	-	
Scale 1:2	Building	File nr. P2001/003-00039		



- 1. Steel column acc. to engineering design of the structure
- 2. Ruukki SP2B PIR
- 3. EA1B16 joint flashing
- 4. Panel fastener for hot-rolled column or for cold-bent column
- 5. L03 fastener (every 500 mm)
- 6. Impregnated polyurethane sealant or expanding foam
- 7. Permanently elastic sealing compound in panel joint